

METRIC

PLATE No
CONT No
 WP No 4245-05-00

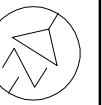

TRILLIUM MUP CLOSURE
 PEDESTRIAN AND CYCLIST
 DETOUR ROUTING

SHEET
 4-1

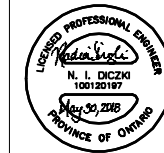

LEGEND	
	PATHWAY CLOSED (DATE)
	NORTHBOUND PEDESTRIAN DETOUR ROUTE
	SOUTHBOUND PEDESTRIAN DETOUR ROUTE
	NORTHBOUND CYCLIST DETOUR ROUTE
	SOUTHBOUND CYCLIST DETOUR ROUTE
	DETOUR TRAILBLAZER SIGNS (DTS) WITH DETOUR NUMBER
	ADVANCE NOTIFICATION SIGNS (ANS) (TC-64)

NOTES:

1. PLACEMENT OF TEMPORARY CONDITIONS SIGNAGE SHALL NOT OBSTRUCT THE VIEW OF EXISTING SIGNAGE.
2. ADVANCE NOTIFICATION SIGNS (ANS) SHALL BE INSTALLED 1 WEEK PRIOR TO THE CLOSURE BY OTHERS.
3. ADVANCE WARNING SIGNS AND DETOUR TRAILBLAZER SIGNS SHALL BE INSTALLED AND REMAIN IN PLACE DURING THE CLOSURE. TABS SHALL BE USED TO CHANGE SIGNS FROM ADVANCE NOTIFICATION TO ADVANCE WARNING TO BE COMPLETED BY OTHERS.

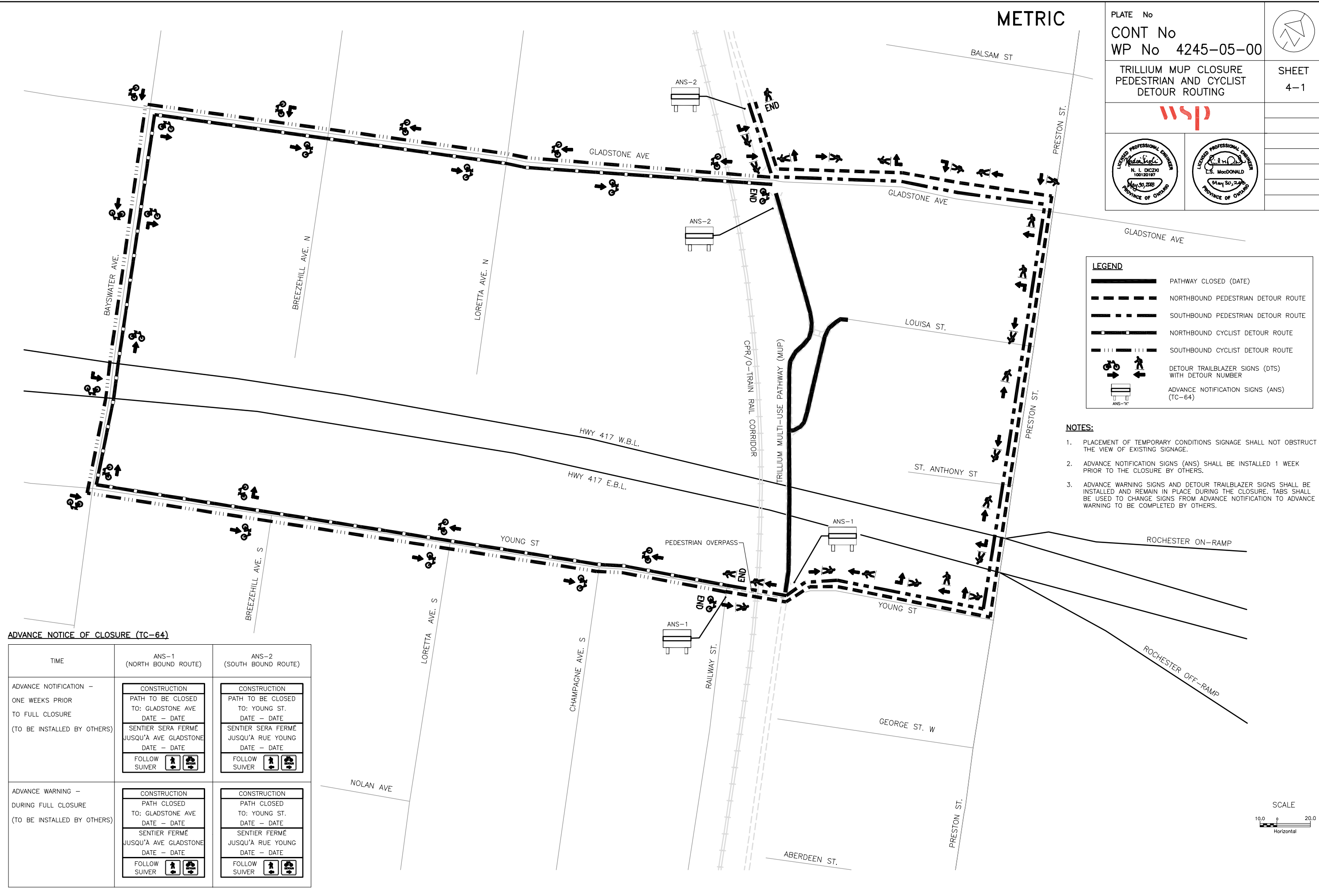

ADVANCE NOTICE OF CLOSURE (TC-64)

TIME	ANS-1 (NORTH BOUND ROUTE)	ANS-2 (SOUTH BOUND ROUTE)								
ADVANCE NOTIFICATION - ONE WEEKS PRIOR TO FULL CLOSURE (TO BE INSTALLED BY OTHERS)	<table border="1"> <tr><td>CONSTRUCTION</td></tr> <tr><td>PATH TO BE CLOSED TO: GLADSTONE AVE DATE - DATE</td></tr> <tr><td>SENTIER SERA FERME JUSQU'À AVE GLADSTONE DATE - DATE</td></tr> <tr><td>FOLLOW SUIVER </td></tr> </table>	CONSTRUCTION	PATH TO BE CLOSED TO: GLADSTONE AVE DATE - DATE	SENTIER SERA FERME JUSQU'À AVE GLADSTONE DATE - DATE	FOLLOW SUIVER	<table border="1"> <tr><td>CONSTRUCTION</td></tr> <tr><td>PATH TO BE CLOSED TO: YOUNG ST. DATE - DATE</td></tr> <tr><td>SENTIER SERA FERME JUSQU'À RUE YOUNG DATE - DATE</td></tr> <tr><td>FOLLOW SUIVER </td></tr> </table>	CONSTRUCTION	PATH TO BE CLOSED TO: YOUNG ST. DATE - DATE	SENTIER SERA FERME JUSQU'À RUE YOUNG DATE - DATE	FOLLOW SUIVER
CONSTRUCTION										
PATH TO BE CLOSED TO: GLADSTONE AVE DATE - DATE										
SENTIER SERA FERME JUSQU'À AVE GLADSTONE DATE - DATE										
FOLLOW SUIVER										
CONSTRUCTION										
PATH TO BE CLOSED TO: YOUNG ST. DATE - DATE										
SENTIER SERA FERME JUSQU'À RUE YOUNG DATE - DATE										
FOLLOW SUIVER										
ADVANCE WARNING - DURING FULL CLOSURE (TO BE INSTALLED BY OTHERS)	<table border="1"> <tr><td>CONSTRUCTION</td></tr> <tr><td>PATH CLOSED TO: GLADSTONE AVE DATE - DATE</td></tr> <tr><td>SENTIER FERMÉ JUSQU'À AVE GLADSTONE DATE - DATE</td></tr> <tr><td>FOLLOW SUIVER </td></tr> </table>	CONSTRUCTION	PATH CLOSED TO: GLADSTONE AVE DATE - DATE	SENTIER FERMÉ JUSQU'À AVE GLADSTONE DATE - DATE	FOLLOW SUIVER	<table border="1"> <tr><td>CONSTRUCTION</td></tr> <tr><td>PATH CLOSED TO: YOUNG ST. DATE - DATE</td></tr> <tr><td>SENTIER FERMÉ JUSQU'À RUE YOUNG DATE - DATE</td></tr> <tr><td>FOLLOW SUIVER </td></tr> </table>	CONSTRUCTION	PATH CLOSED TO: YOUNG ST. DATE - DATE	SENTIER FERMÉ JUSQU'À RUE YOUNG DATE - DATE	FOLLOW SUIVER
CONSTRUCTION										
PATH CLOSED TO: GLADSTONE AVE DATE - DATE										
SENTIER FERMÉ JUSQU'À AVE GLADSTONE DATE - DATE										
FOLLOW SUIVER										
CONSTRUCTION										
PATH CLOSED TO: YOUNG ST. DATE - DATE										
SENTIER FERMÉ JUSQU'À RUE YOUNG DATE - DATE										
FOLLOW SUIVER										

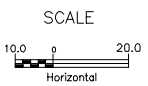

FILE LOCATION: C:\3416014 HWY 417 O-TRAIN\CURRENT\CONTRACT 2\SHEETS\
 DRAWING NAME: 004-1-C2-3416014-DETOUR CYCLE ROUTING.DWG
 DRAWN BY: S.C.
 16.38.45
 Revised
 MODIFIED: 18/05/21

MINISTRY OF TRANSPORTATION, ONTARIO
 PP-0-707
 08-05